

5/26/20

* "PATCHING EXISTING PAVEMENT" HAS BEEN INCLUDED AS A PAY ITEM ON MAPS. PATCHING MAY OR MAY NOT BE NEEDED DEPENDING ON CONDITION OF MAP SURFACE AT TIME THAT PAVING SEASON BEGINS. AREAS TO BE DELINIATED BY THE ENGINEER.

* INCIDENTAL MILLING AT LOCATIONS AS DIRECTED BY THE ENGINEER

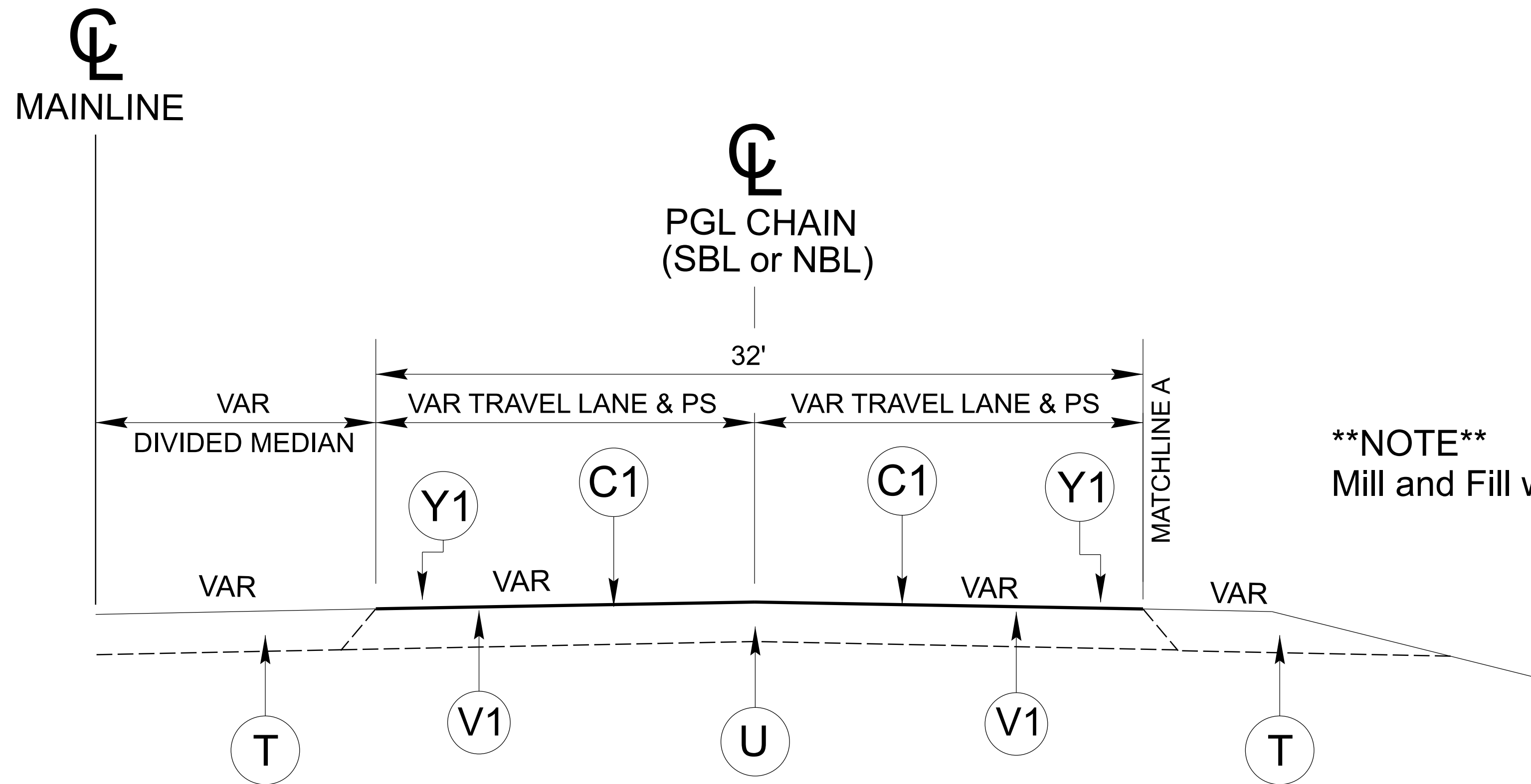

TYPICAL SECTION NO. 1

**MAP 1 - US 421 NB FROM MILE POST 11.41 TO BRIDGE #227

**MAP 2 - US 421 SB FROM BRIDGE #228 TO MILE POST 9.92

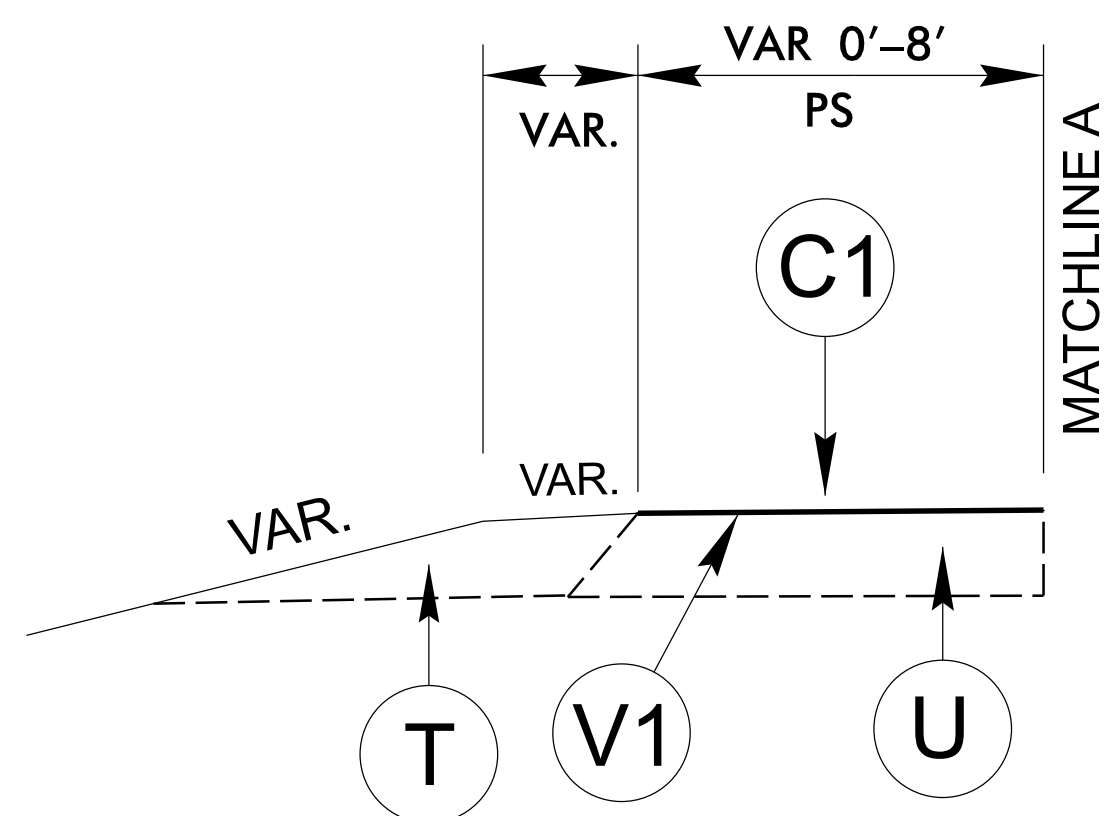

INSET NO. 1A **

NOTE: INSET NO. 1A IS MIRRORED THE SAME ON LT AND RT SIDES

MAP 1 - VARIOUS SPOT LOCATIONS ALONG US 421 NORTHBOUND SHOULDER

MAP 2 - VARIOUS SPOT LOCATIONS ALONG US 421 SOUTHBOUND SHOULDER

PAVEMENT SCHEDULE	
C1	PROP. APPROX. 1½" ASPHALT CONCRETE SURFACE COURSE, TYPE S9.5C, AN AVERAGE RATE OF 168 LBS. PER SQ. YD.
T	SHOULDER RECONSTRUCTION
U	EXISTING PAVEMENT
V1	MILLING OF EXISTING ASPHALT PAVEMENT AT DEPTH OF 1½"
V2	INCIDENTAL MILLING (See Tie in Detail)
Y1	MILLED RUMBLE STRIPS (16")

****NOTE****
Mill and Fill with 1.5" S9.5C

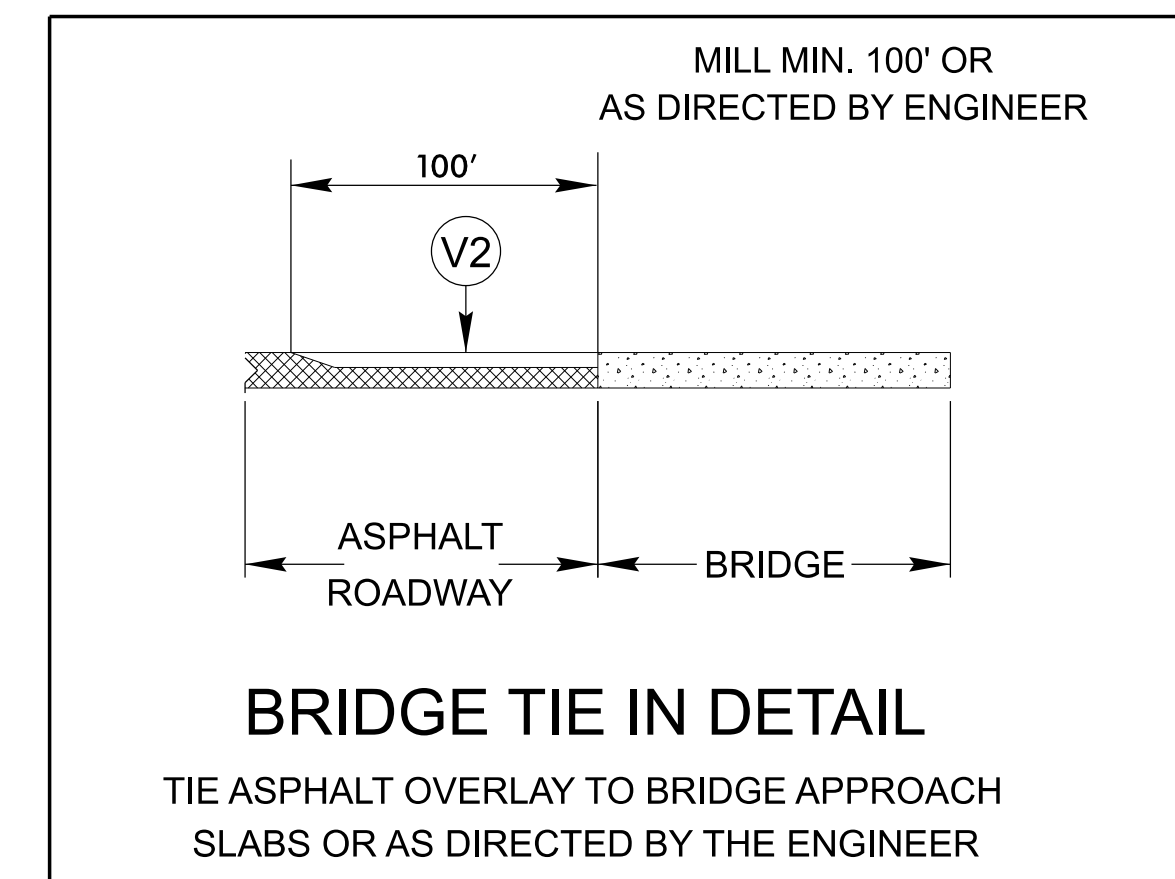
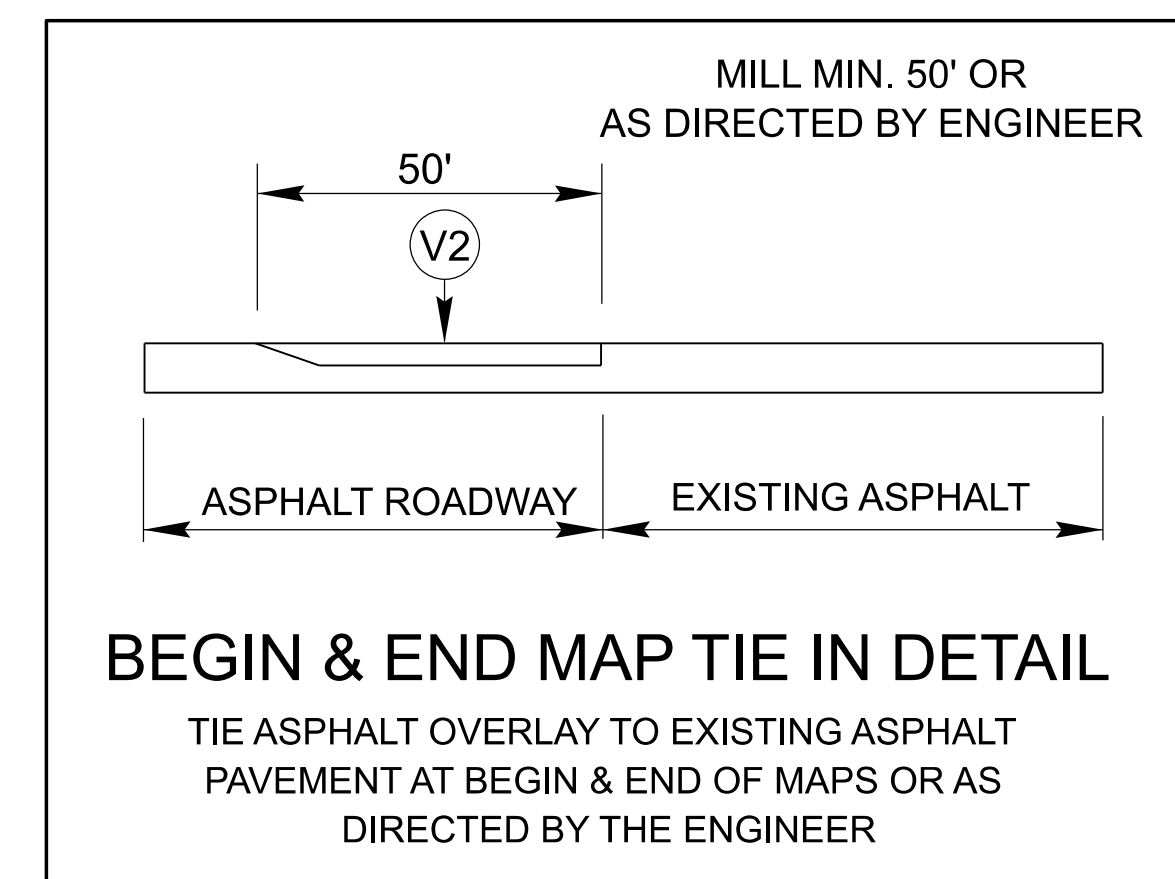

NOTE: TYPICALS ARE NOT TO SCALE

DK00448

001

NORTH CAROLINA
DEPARTMENT OF TRANSPORTATION
DIVISION OF HIGHWAYS

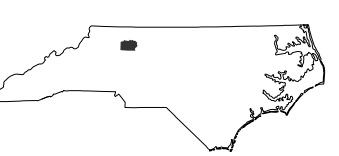

DIVISION ELEVEN

YADKIN COUNTY

PRIMARY
AND
SECONDARY
ROADS

2026
ASPHALT
RESURFACING

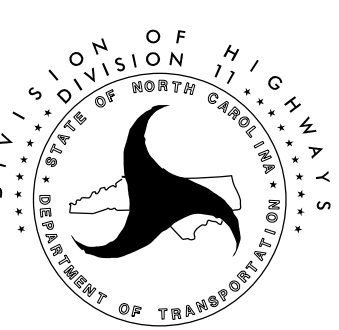

DATE: 10/21/2025
PREPARED BY: DLH

REVISIONS

5/26/20

* INCIDENTAL MILLING AT LOCATIONS AS DIRECTED BY THE ENGINEER

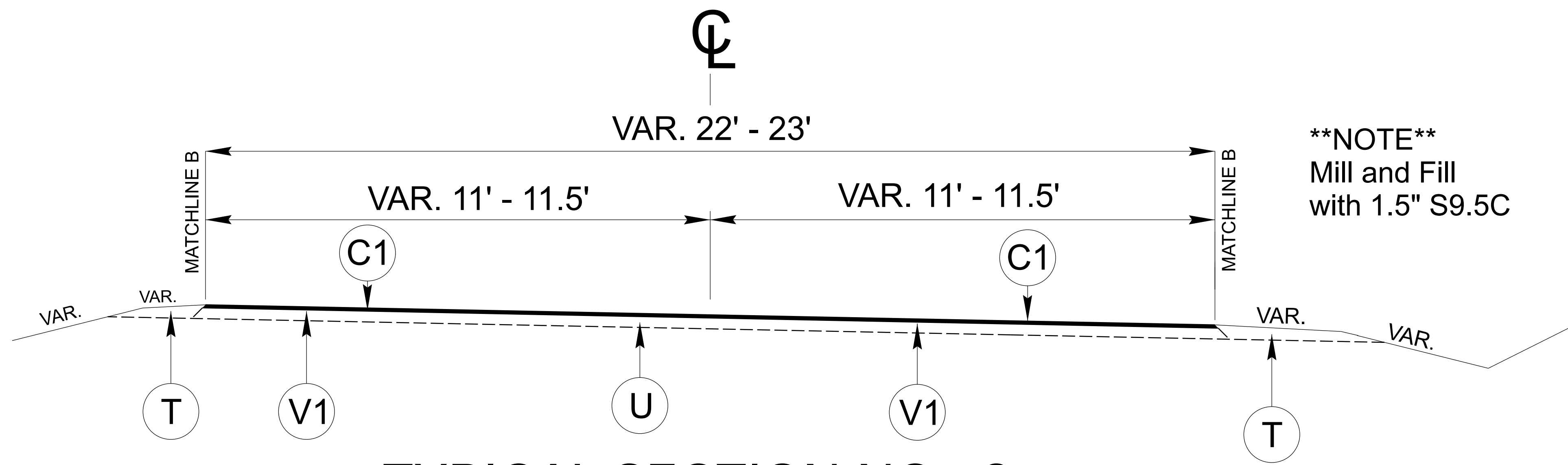

TYPICAL SECTION NO. 2

- MAP 3 - RMP-2599 (NB ON RAMP) FROM SR 1141 TO US 421 NB
- MAP 4 - RMP-2600 (SB OFF RAMP) FROM US 421 SB TO SR 1141
- MAP 5 - RMP-2594 (NB OFF RAMP) FROM US 421 NB TO SR 1141
- MAP 6 - RMP-2593 (SB ON RAMP) FROM US 21 TO US 421 SB

PAVEMENT SCHEDULE	
C1	PROP. APPROX. 1 1/2" ASPHALT CONCRETE SURFACE COURSE, TYPE S9.5C, AN AVERAGE RATE OF 168 LBS. PER SQ. YD.
T	SHOULDER RECONSTRUCTION
U	EXISTING PAVEMENT
V1	MILLING OF EXISTING ASPHALT PAVEMENT AT DEPTH OF 1 1/2"
V2	INCIDENTAL MILLING (See Tie in Detail)

****NOTE****
Mill and Fill
with 1.5" S9.5C

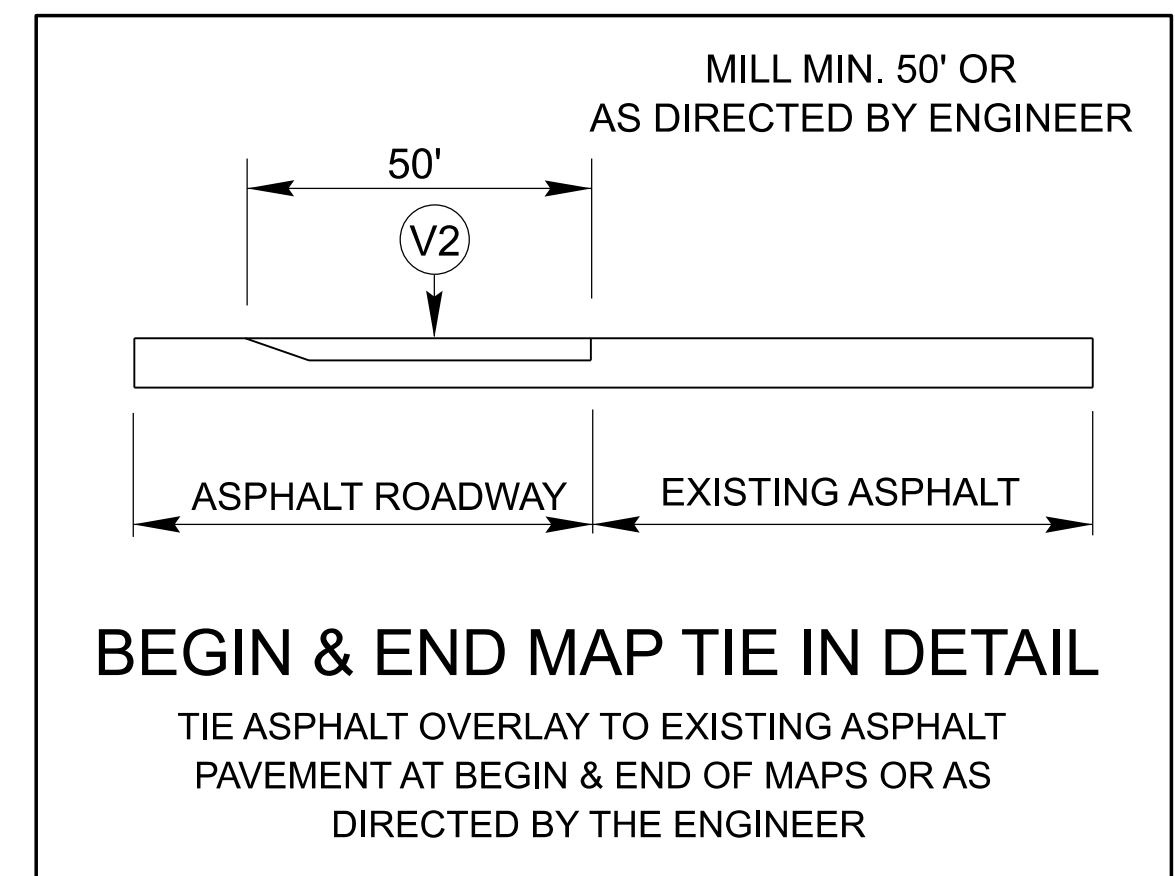

NOTE: TYPICALS ARE NOT TO SCALE

DK00448

002

NORTH CAROLINA
DEPARTMENT OF TRANSPORTATION
DIVISION OF HIGHWAYS

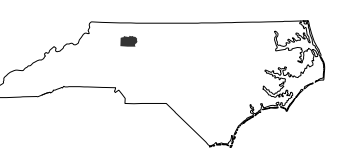

DIVISION ELEVEN

YADKIN COUNTY

PRIMARY
AND
SECONDARY
ROADS

2026
ASPHALT
RESURFACING

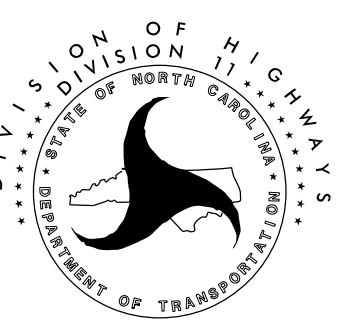

DATE: 10/21/2025
PREPARED BY: DLH

REVISIONS

5/26/20

* INCIDENTAL MILLING AT LOCATIONS AS DIRECTED BY THE ENGINEER

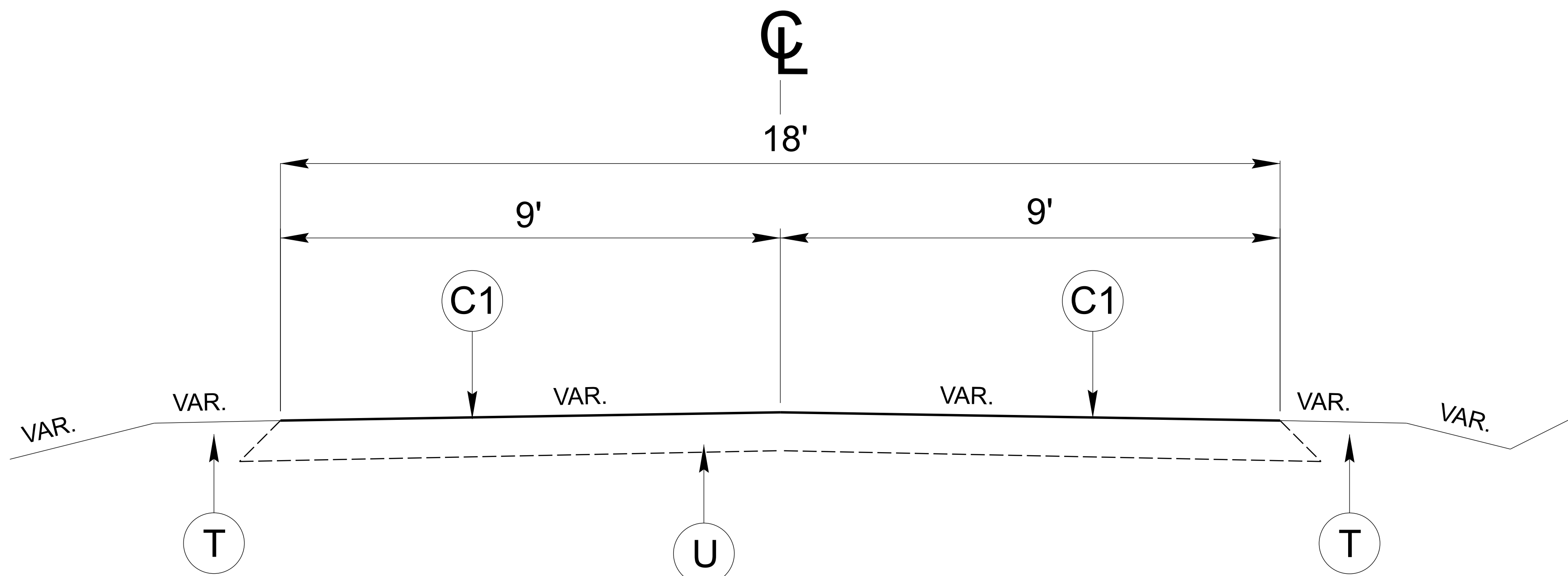

TYPICAL SECTION NO. 3

MAP 7 - SR 1538 SHADY GROVE CHURCH RD FROM SR 1541 TO SR 1537
 *MAP 8 - SR 1538 SHADY GROVE CHURCH RD FROM SR 1537 TO SR 1645
 *(See Typical No.4 for bridge overlay locations)

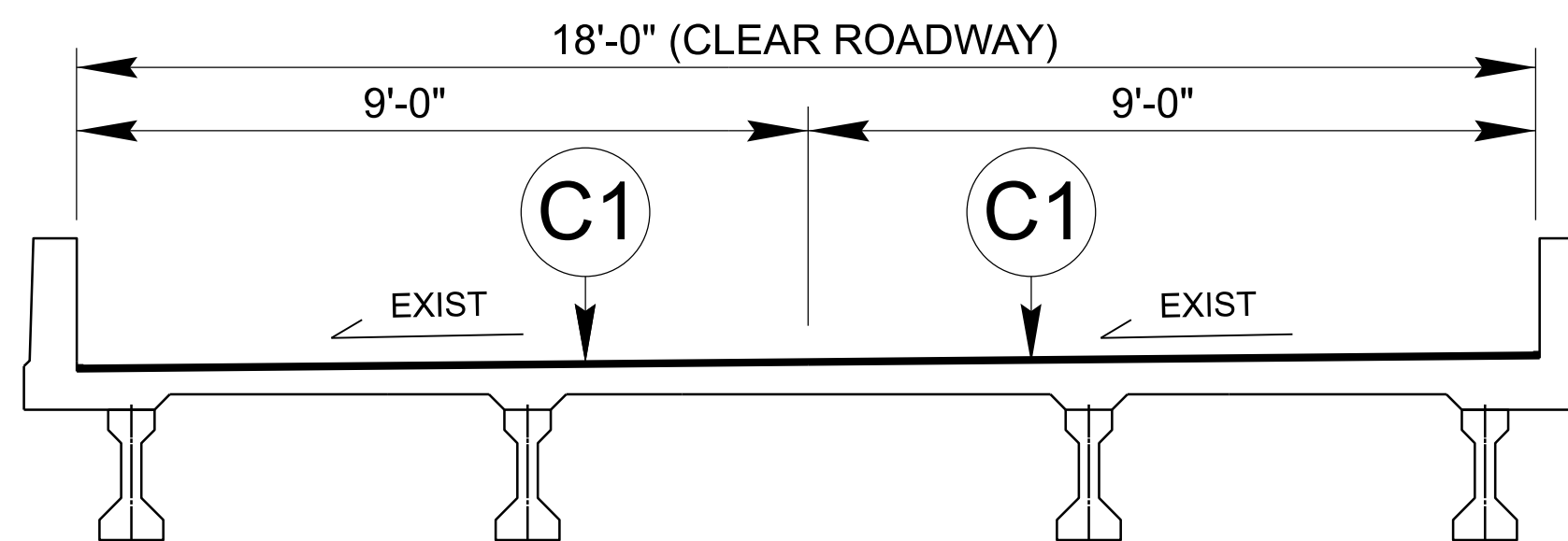

NOTE: EXISTING BRIDGE SUPERSTRUCTURE #99

TYPICAL SECTION NO. 4

MAP 8 - SR 1538 SHADY GROVE CHURCH RD FROM MP 2.83 TO 2.85

PAVEMENT SCHEDULE	
C1	PROP. APPROX. 1½" ASPHALT CONCRETE SURFACE COURSE, TYPE S9.5C, AN AVERAGE RATE OF 168 LBS. PER SQ. YD.
T	SHOULDER RECONSTRUCTION
U	EXISTING PAVEMENT
V1	MILLING OF EXISTING ASPHALT PAVEMENT AT DEPTH OF 1½"
V2	INCIDENTAL MILLING (See Tie in Detail)

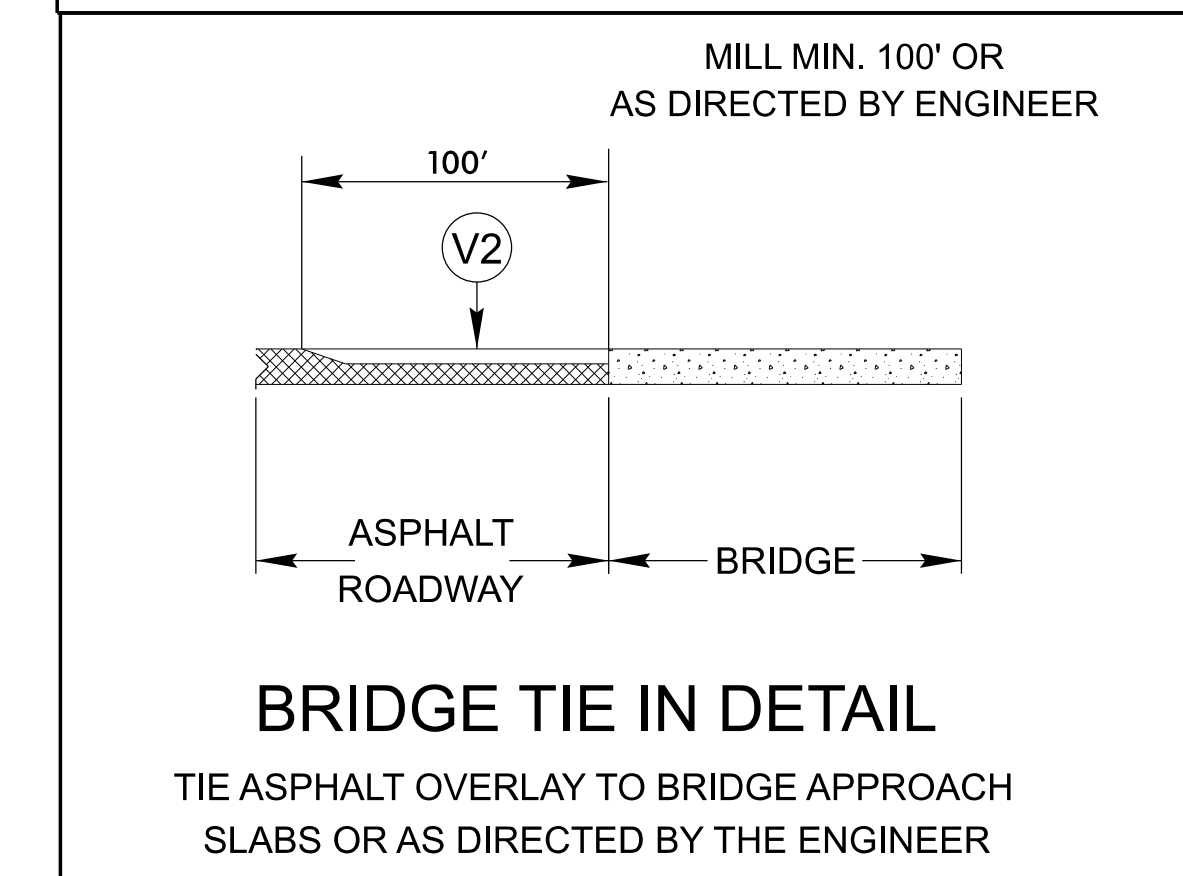
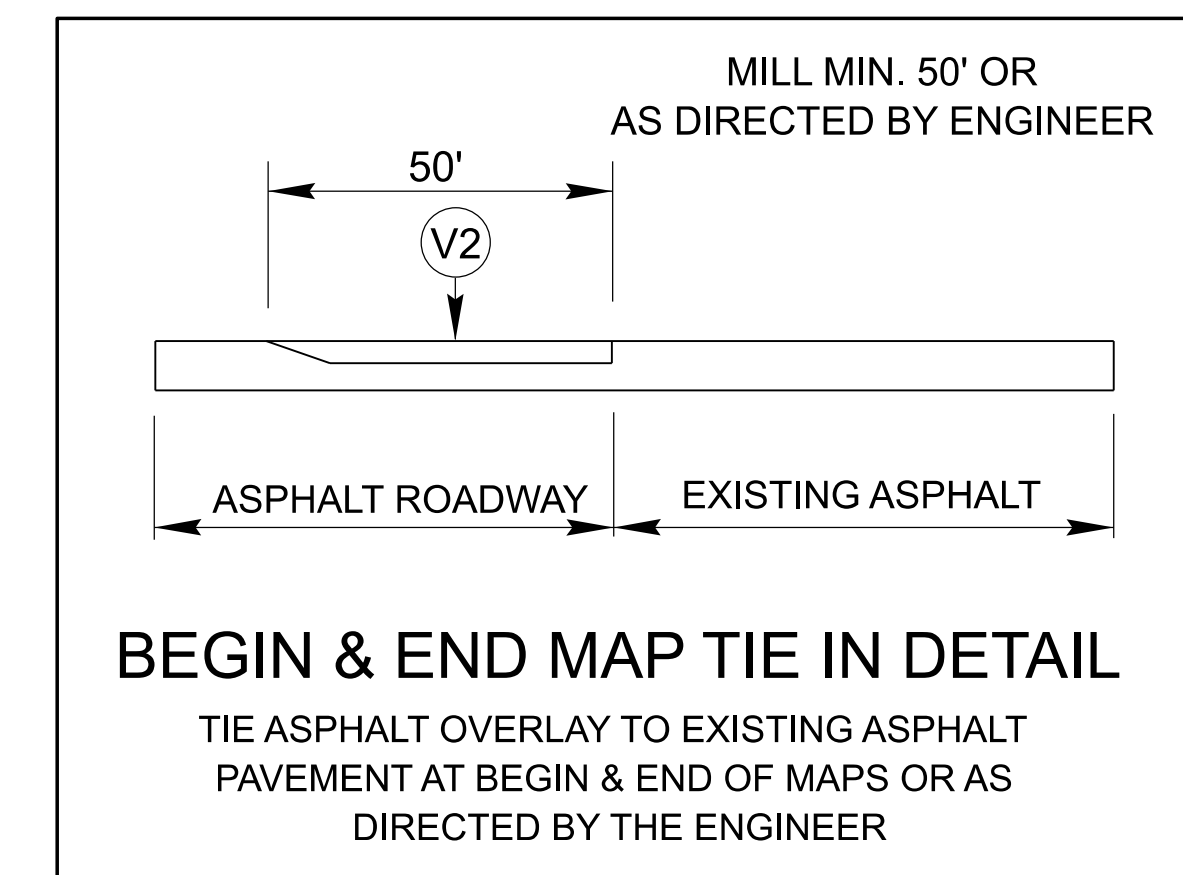

NOTE: TYPICALS ARE NOT TO SCALE

DK00448

003

NORTH CAROLINA DEPARTMENT OF TRANSPORTATION DIVISION OF HIGHWAYS

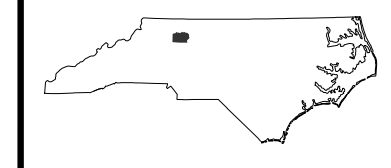

DIVISION ELEVEN

YADKIN COUNTY

PRIMARY AND SECONDARY ROADS

2026 ASPHALT RESURFACING

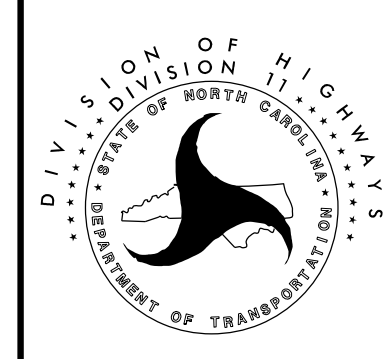

DATE: 10/21/2025 PREPARED BY: DLH

REVISIONS

SUMMARY OF QUANTITIES

PROJECT NO	COUNTY	MAP NO	ROUTE	DESCRIPTION	TYP NO	LANES	LANE TYPE	LENGTH	WIDTH	BEGIN MP	END MP	1245000000-E	1245000000-E	1260000000-E	1297000000-E	1330000000-E	1523000000-E	1575000000-E	1704000000-E	1840000000-E	
												INCIDENTAL STONE BASE	SHOULDER RECONSTRUCTION	AGGREGATE SHOULDER BORROW	1½" MILLING	INCIDENTAL MILLING	SURFACE COURSE, S9.5C	ASPHALT BINDER FOR PLANT MIX	PATCHING EXISTING PAVEMENT	MILLED RUMBLE STRIPS (ASPHALT CONCRETE), 16"	
												TON	SMI	TON	SY	SY	TONS	TONS	TONS	LF	
2026CPT.11.04.10991	Yadkin	1	US 421 NORTH	FROM MILE POST 11.41 TO US 21 BRIDGE	1	2	MD	3.69	32	11.41	15.1		1.00	100	69,274	178	6,692	442		38,966	
2026CPT.11.04.10991	Yadkin	2	US-421 SOUTH	FROM MILE POST US 21 BRIDGE TO MILE POST 9.92	1	2	MD	3.68	32	6.22	9.9		1.00	100	69,086	178	6,674	441		38,861	
TOTAL FOR PROJ NO. 2026CPT.11.04.10991								7.37					2.00	200.00	138,360.00	356.00	13,366.00	883.00		77,827.00	
2026CPT.11.04.20991	Yadkin	3	RAMP 2599	FROM SR 1141 TU US 421 NORTH BOUND	1	2	MD	0.4	22	0	0.4		0.80	110	4,568	188	441	29			
2026CPT.11.04.20991	Yadkin	4	RAMP 2600	FROM US 421 S TO SR 1141	1	2	MD	0.32	22	0	0.32		0.64	88	5,010	1,688	484	32			
2026CPT.11.04.20991	Yadkin	5	RAMP 2594	FROM US 421 NORTH BOUND TO SR 1141	1	2	MD	0.32	22	0	0.32		0.64	88	5,010	993	505	33			
2026CPT.11.04.20991	Yadkin	6	RAMP 2593	FROM US 21 TO US 421 SOUTH BOUND	1	2	MD	0.44	23	0	0.44		0.88	121	5,322	750	514	34			
2026CPT.11.04.20991	Yadkin	7	SR-1538 (SHADY GROVE CHURCH ROAD)	FROM SR 1541 TO SR 1537	2	2	MD	2.11	18	0.01	2.12	50	4.22	580		400	2,152	142	200		
2026CPT.11.04.20991	Yadkin	8	SR-1538 (SHADY GROVE CHURCH ROAD)	FROM SR 1537 TO SR 1645	2	2	MD	2.44	18	2.12	4.56	50	4.88	671		400	2,489	165	200		
TOTAL FOR PROJ NO. 2026CPT.11.04.20991								6.03					100.00	12.06	1,658.00	19,910.00	4,419.00	6,585.00	435.00	400.00	
GRAND TOTAL								13.4					100.00	14.06	1,858.00	158,270.00	4,775.00	19,951.00	1,318.00	400.00	77,827.00

DK00448 2026 RESURFACING YADKIN COUNTY PRIMARY AND SECONDARY															PROJECT NO. DK00448		SHEET NO. 5			
THERMOPLASTIC AND PAINT QUANTITIES																				
PROJECT NO	COUNTY	MAP NO	ROUTE	DESCRIPTION	TYP NO	LANES	LANE TYPE	LENGTH	WIDTH	BEGIN MP	END MP	4400000000-E		4725000000-E				4890000000-E		4895000000-N
								MI	FT			STATIONARY WORK ZONE SIGN	EA	EA	EA	EA	EA	EA	EA	EA
2026CPT.11.04.10991	Yadkin	1	US 421 NORTH	FROM MILE POST 11.41 TO US 21 BRIDGE	1	2	MD	3.69	32	11.41	15.1	250						38,966	244	
2026CPT.11.04.10991	Yadkin	2	US 421 SOUTH	FROM MILE POST US 21 BRIDGE TO MILE POST 9.92	1	2	MD	3.68	32	6.22	9.9	250						38,861	243	
TOTAL FOR PROJ NO. 2026CPT.11.04.10991								7.37				500.00						77,827.00	487.00	
2026CPT.11.04.10991	Yadkin	3	RAMP 2599	FROM SR 1141 TU US 421 NORTH BOUND	1	2	MD	0.4	22	0	0.4	112	3					4,224	26	
2026CPT.11.04.10991	Yadkin	4	RAMP 2600	FROM US 421 S TO SR 1141	1	2	MD	0.32	22	0	0.32	112		1	1	1		3,379	21	
2026CPT.11.04.10991	Yadkin	5	RAMP 2594	FROM US 421 NORTH BOUND TO SR 1141	1	2	MD	0.32	22	0	0.32	112		1	2	2		3,379	21	
2026CPT.11.04.10991	Yadkin	6	RAMP 2593	FROM US 21 TO US 421 SOUTH BOUND	1	2	MD	0.44	23	0	0.44	112	3			2		4,646	29	
2026CPT.11.04.10991	Yadkin	7	SR-1538 (SHADY GROVE CHURCH ROAD)	FROM SR 1541 TO SR 1537	2	2	MD	2.11	18	0.01	2.12	250							22,282	
2026CPT.11.04.10991	Yadkin	8	SR-1538 (SHADY GROVE CHURCH ROAD)	FROM SR 1537 TO SR 1645	2	2	MD	2.44	18	2.12	4.56	250							25,766	
TOTAL FOR PROJ NO. 2026CPT.11.04.10991								6.03				948	6	2	3	5		15,628	48,048	97
														16			63,676			
GRAND TOTAL								13.4				1,448	6	2	3	5		93,455	48,048	584
														16			141,503			

[Mile Post Map](#)

Yadkin County DK00448 Yadkin CR 2026 Map # 1 and 2



- BRIDGE
- DK00448 Yadkin 421

Map # 1
US 421 North
FROM MP 11.41
TO US 21 Bridge

Map # 2
US 421 South
FROM US 21 Bridge
TO MP 9.92

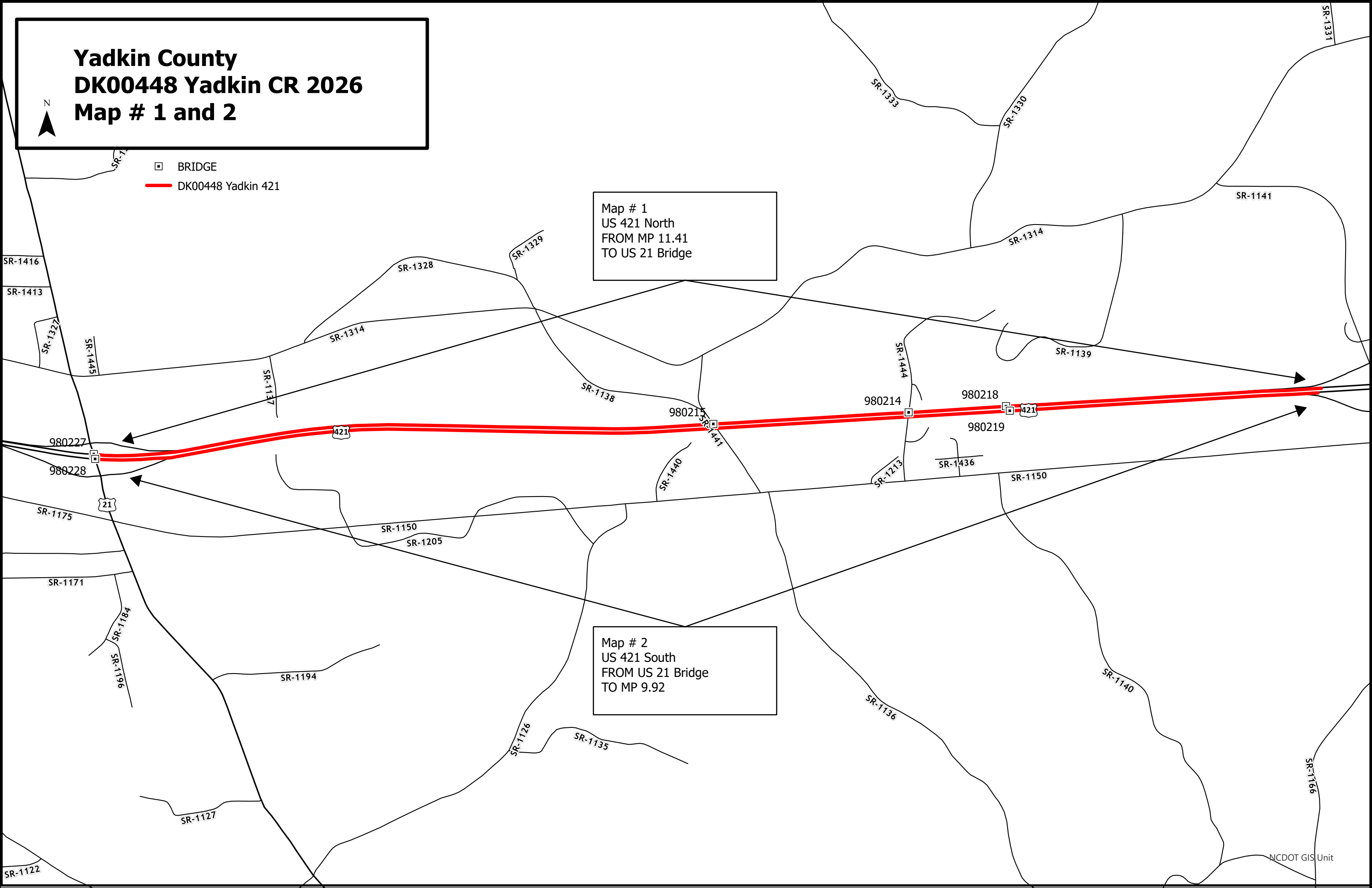

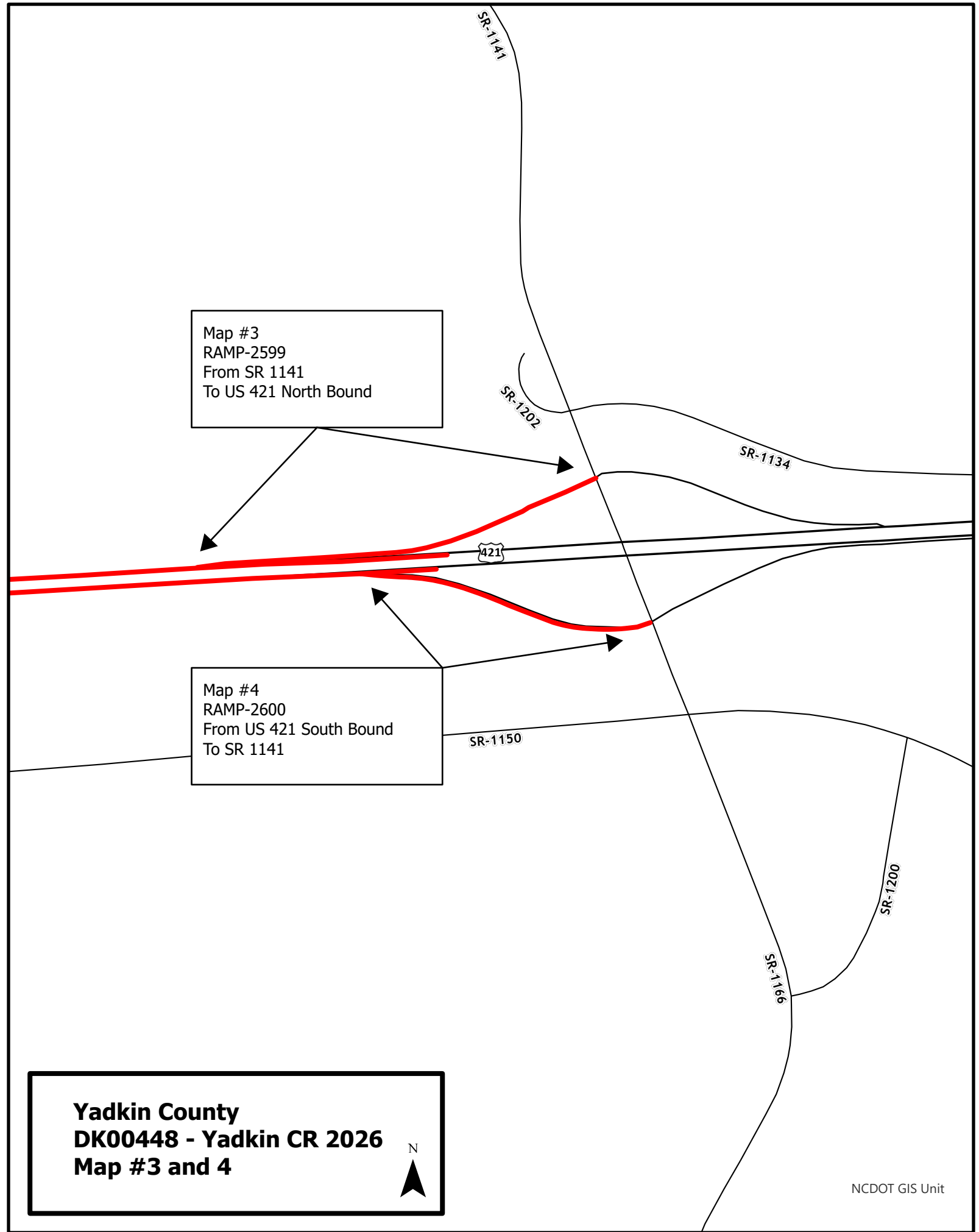
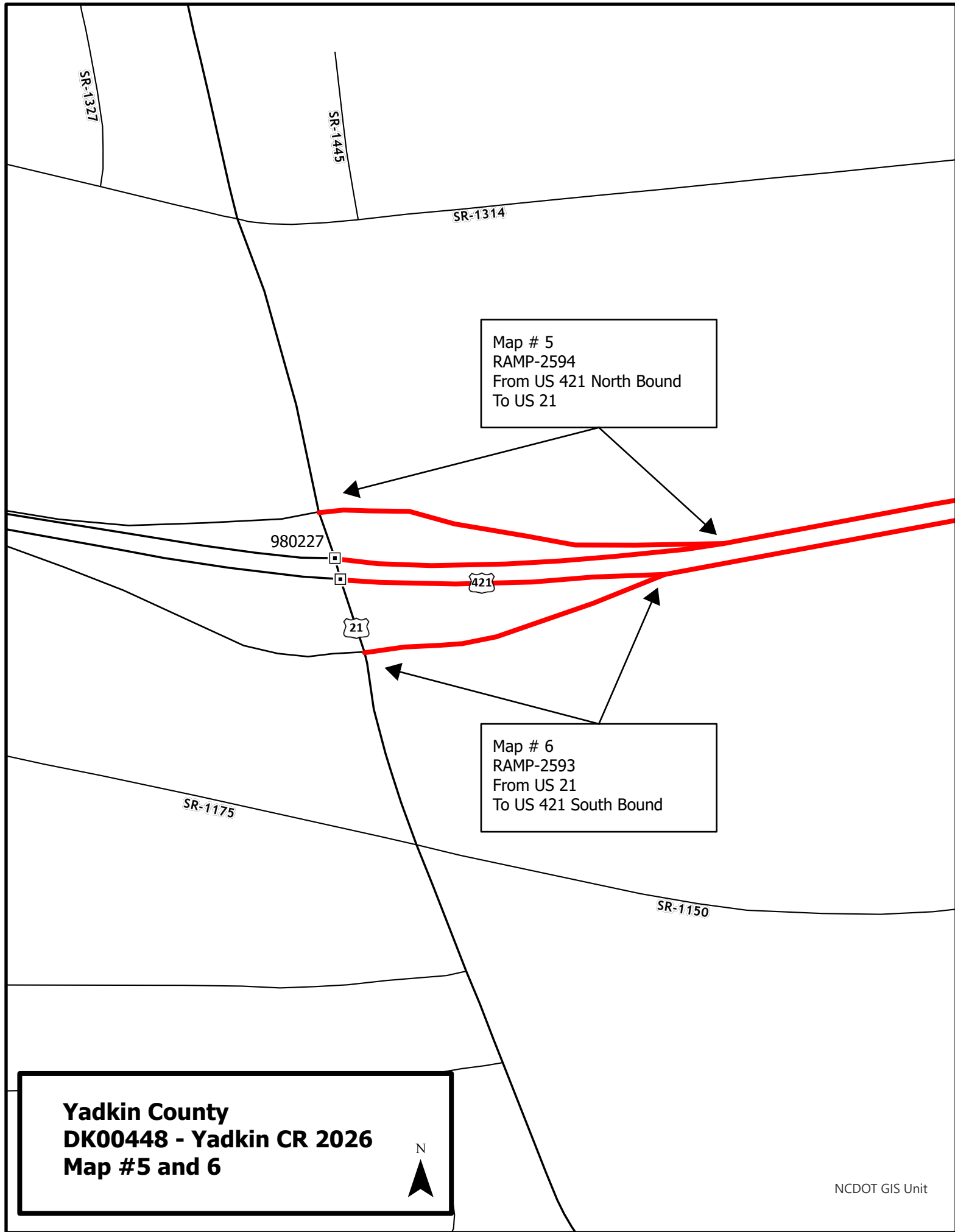

Yadkin County DK00448 Yadkin CR 2026 Map # 7 and 8



DK00448 Yadkin 2026



Map # 7
SR 1538 - Shady Grove
Church Rd
FROM SR 1541
TO SR 1537

Map # 8
SR 1538 - Shady Grove
Church Rd
FROM SR 1537
TO SR 1645

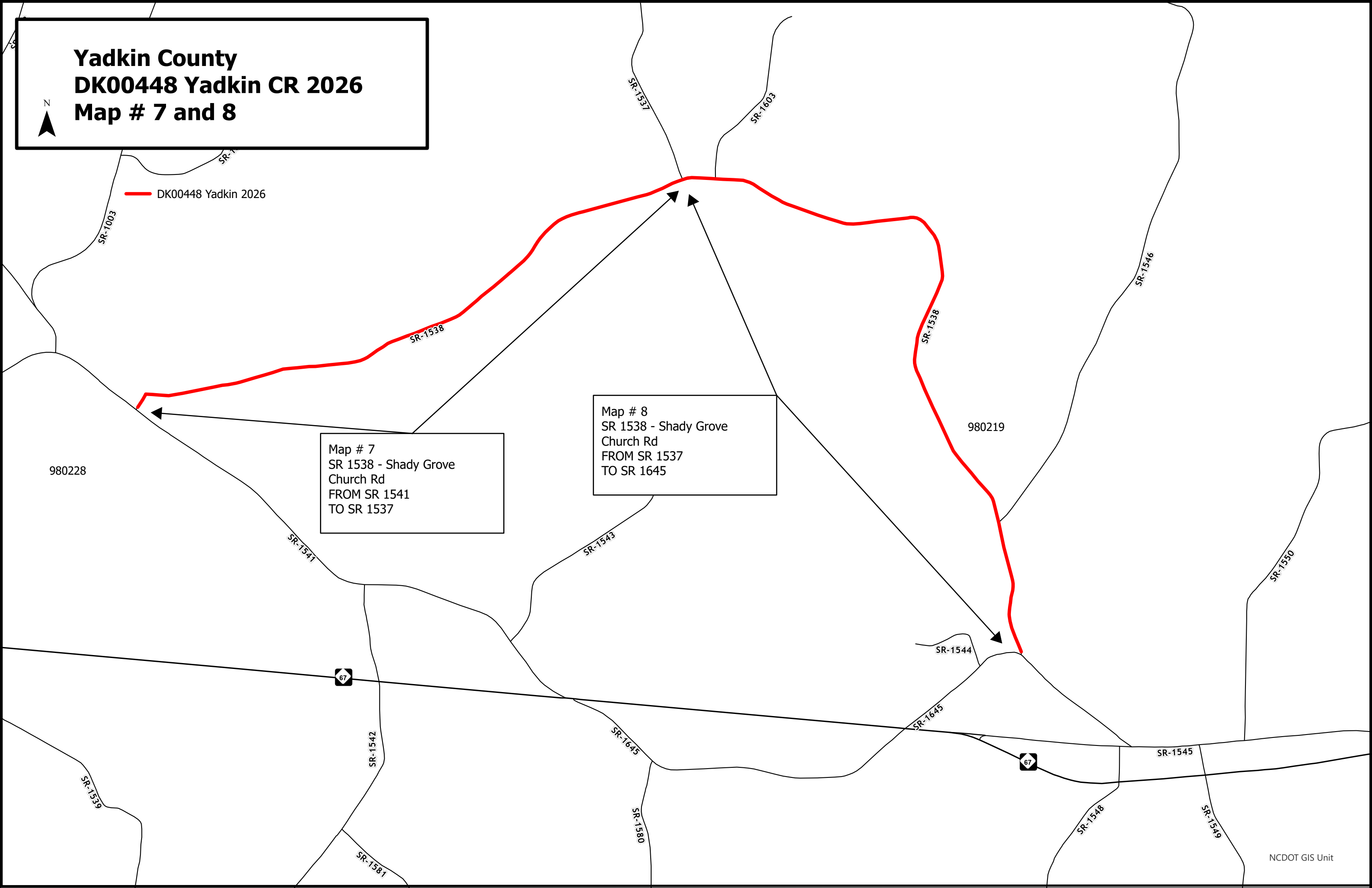

- NOTES:
- 1) DETAIL DOES NOT APPLY TO OGAFc AND ULTRA-THIN BONDED WEARING COURSE.
 - 2) BACKFILL SHOULDER WITH APPROVED MATERIAL.
 - 3) THE SHOULDER WEDGE DEVICE MAY BE DISENGAGED AT PAVED DRIVEWAYS AND SIDE STREETS.

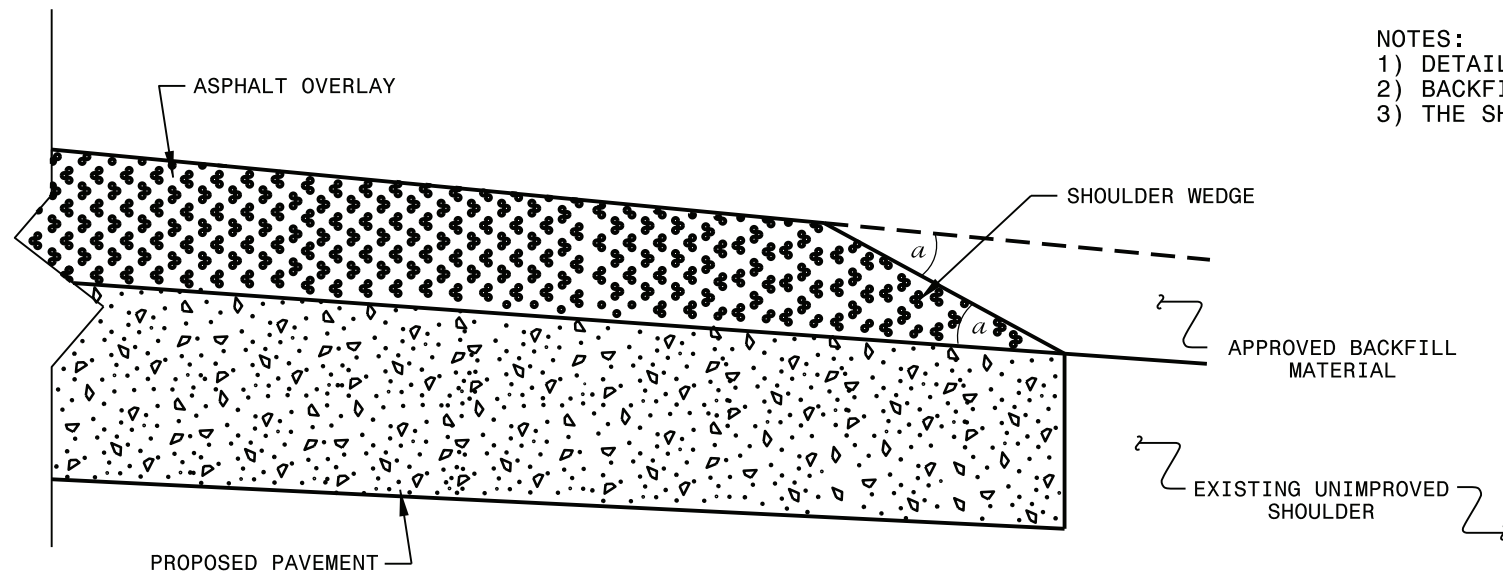

SHOULDER WEDGE DETAIL
(Resurfacing Projects w/ Widening or with Existing Paved Shoulder having no dropoffs)

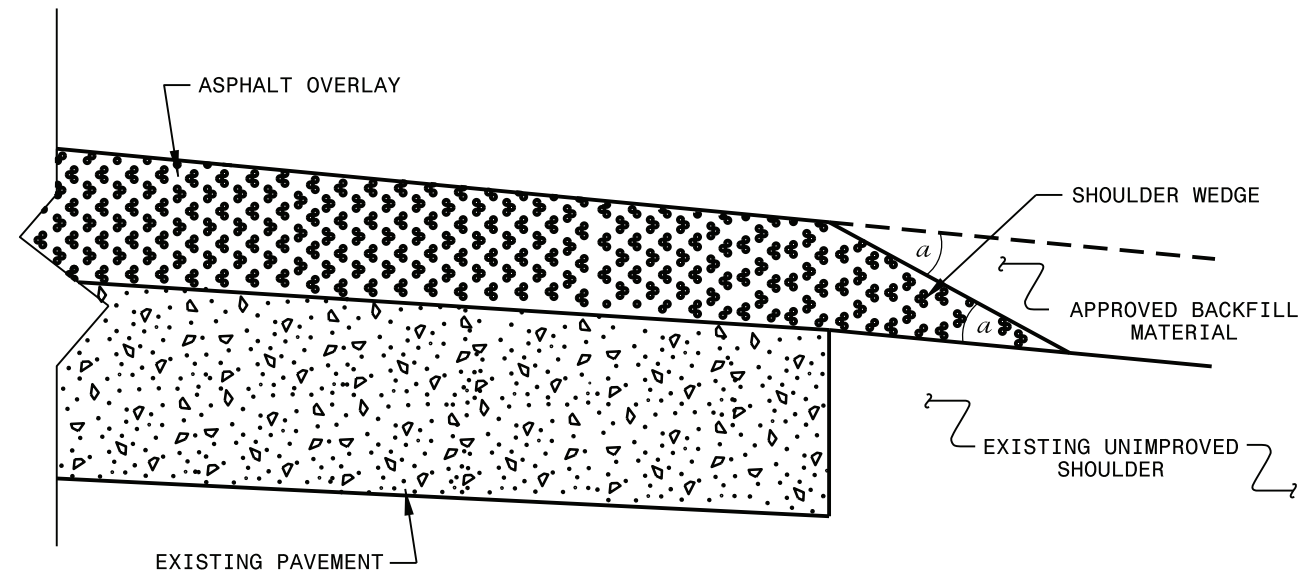

SHOULDER WEDGE DETAIL
(Resurfacing Projects w/ NO Widening)

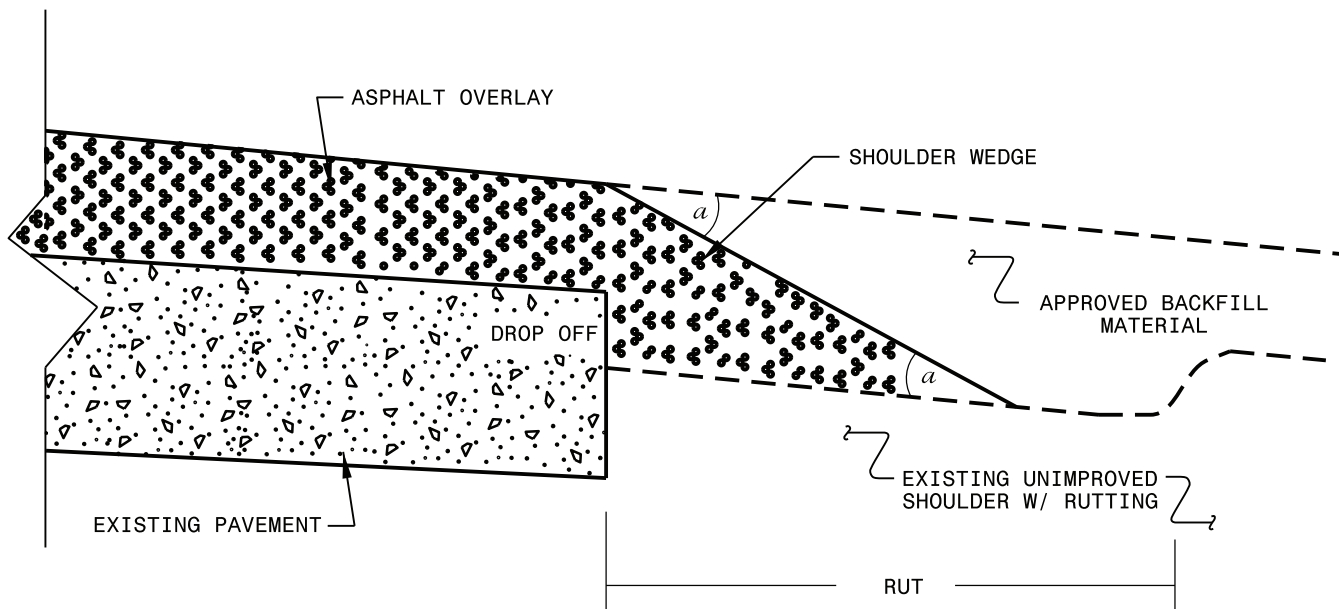

SHOULDER WEDGE DETAIL
(Resurfacing Adjacent to Rutted Shoulder)

- SHOULDER WEDGE ANGLE = 30°

CONTRACT STANDARDS AND DEVELOPMENT UNIT			
Office 919-707-6950		FAX 919-250-4119	
SHOULDER WEDGE DETAILS			
ORIGINAL BY: T.SPELL	DATE: 7-19-11		
MODIFIED BY:	DATE: 10/16/12		
CHECKED BY:	DATE:		
FILE SPEC.: susr/details/stand/shoulderwedgedetail.dgn			

SYSTEMS DESIGN
 USER NAME

DIVIDED MEDIANS WITH WIDTHS 46' OR GREATER

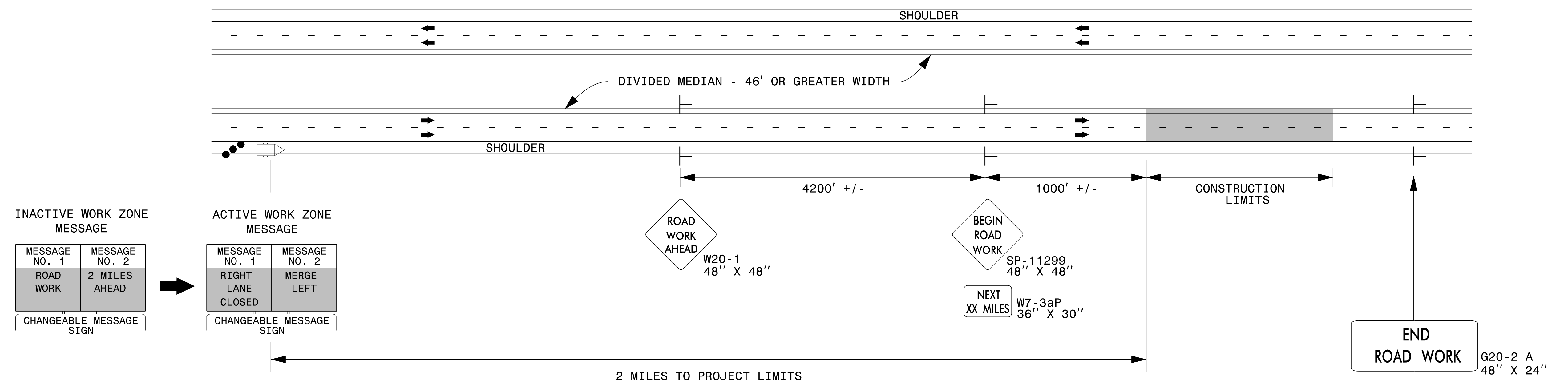

DIVIDED MEDIANS WITH WIDTHS LESS THAN 46' OR WITH PERMANENT MEDIAN BARRIER

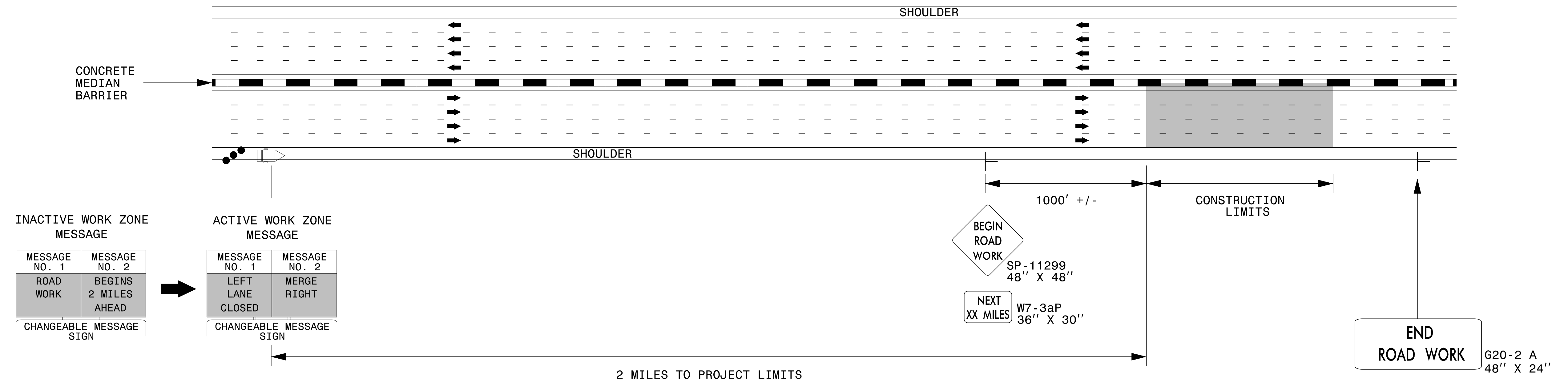

NOTES:

- 1) LATERAL CLEARANCE AT ALL SIGN LOCATIONS SHALL BE 6' AS MEASURED FROM THE EDGE OF PAVEMENT.
- 2) MOUNT SIGNS THAT ARE LARGER THAN 10 SQUARE FEET IN AREA ON TWO OR MORE WOOD OR U-CHANNEL SUPPORTS. PERFORATED SQUARE TUBING SUPPORT SYSTEMS MAY SUPPORT LARGER AREAS ON A SINGLE SUPPORT. FOLLOW MANUFACTURER'S RECOMMENDATIONS. THESE SYSTEMS SHALL BE NCHRP 350 COMPLIANT AND NCDOT APPROVED.
- 3) FOR MEDIAN WIDTHS LESS THAN 46' (MEASURED EDGELINE TO EDGELINE) USE THE BOTTOM DRAWING.
- 4) IF STATIONARY GENERAL WARNING SIGNS ARE USED, THEY WILL BE PAID FOR PER SECTION 104 OF THE NCDOT STANDARD SPECIFICATIONS AS EXTRA WORK.
- 5) INSTALL "ROAD WORK AHEAD" (W20-1) ALONG ENTRANCE RAMP 500' PRIOR TO RAMP TERMINAL, AND "END ROAD WORK" (G20-2a) AT THE END OF EXIT RAMP WITHIN THE WORK ZONE.
- 6) IF MILLED AREAS ARE NOT PAVED BACK BY THE END OF THE WORK DAY, PORTABLE SIGNS SHALL BE USED TO WARN DRIVERS OF THE PRESENT CONDITIONS. THESE ARE TO INCLUDE, BUT NOT LIMITED TO "ROUGH ROAD" W8-8, "UNEVEN LANES" W8-11, "GROOVED PAVEMENT" W8-15 w/MOTORCYCLE PLAQUE MOUNTED BELOW. THESE ARE TO BE DOUBLE INDICATED ON MULTI-LANE ROADWAYS WITH SPEED LIMITS 45 MPH AND GREATER AND WITH DIVIDED MEDIANS OF 46' OR GREATER. THESE PORTABLE SIGNS ARE INCIDENTAL TO THE OTHER ITEMS OF WORK INCLUDED IN THE TEMPORARY TRAFFIC CONTROL (LUMP SUM) PAY ITEM.

LEGEND

- CHANGEABLE MESSAGE SIGN (CMS)
- STATIONARY SIGN
- DIRECTION OF TRAFFIC FLOW
- TRAFFIC DRUM

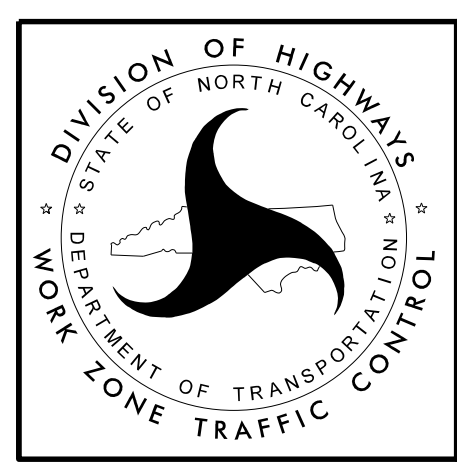

**RESURFACING ADVANCE
WARNING SIGNS FOR
HIGH SPEED FACILITIES
≥ 60 MPH**

3/23/2015 C:\Users\rmgarrrett\Downloads\Resurfacing_AdvWarn_HSpd.dgn User:rmgarrrett

SIGNING FOR RESURFACING PROJECTS

LEGEND
 ┆ STATIONARY SIGN
 ← DIRECTION OF TRAFFIC FLOW

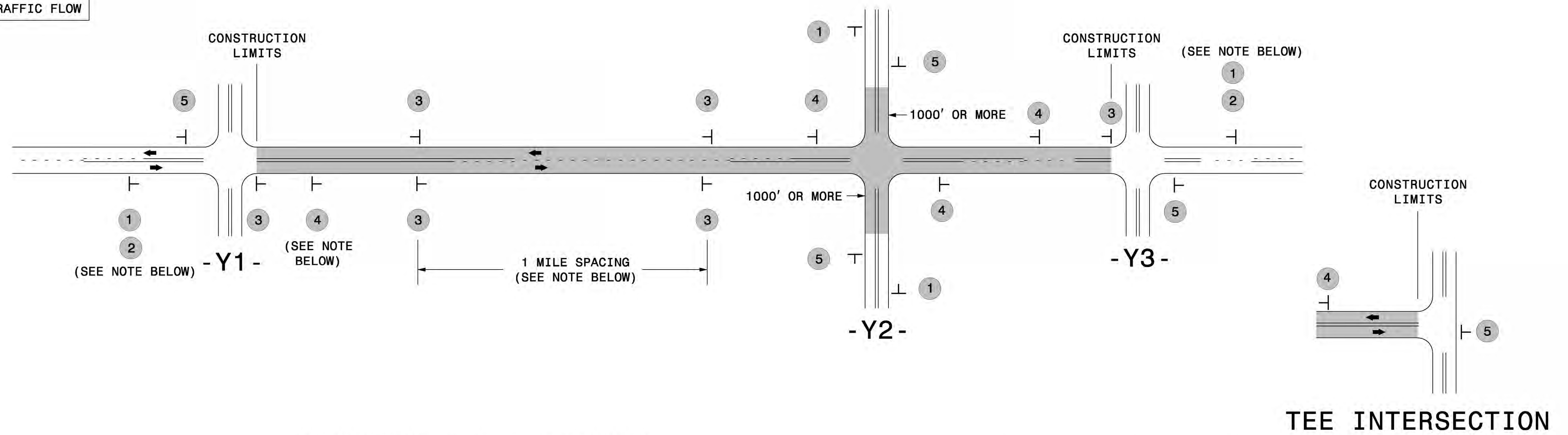

MAINLINE (-L-) SIGNING

-Y- LINE SIGNING

SIGNING NOTES AND PLACEMENT PER DIRECTION	1		PLACE 1000' PRIOR TO BEGINNING OF CONSTRUCTION LIMITS. ONLY USED ON -Y- LINES IF RESURFACING LIMITS EXTEND 1000' ALONG -Y- LINE.	<p>NO REQUIRED STATIONARY SIGNING FOR THE FOLLOWING -Y- LINE CONDITIONS:</p> <ol style="list-style-type: none"> LESS THAN 1000' OF RESURFACING ALONG -Y- LINE SUBDIVISION ROADS DEAD END ROADS <p>WHEN PAVING/CONSTRUCTION ACTIVITIES PROCEED ACROSS AN UNSIGNED -Y- LINE, PORTABLE ADVANCE WARNING SIGNS SHALL BE USED ALONG THE -Y- LINE AS SHOWN BELOW. REMOVE UPON COMPLETION OF WORK.</p> <div style="display: flex; justify-content: space-around;"> <div style="text-align: center;"> W20-1 48" X 48" PLACED 500' IN ADVANCE OF FLAGGER. </div> <div style="text-align: center;"> W20-7 A 48" X 48" PLACED 250' IN ADVANCE OF FLAGGER. </div> </div>
	2		#2 SIGN ONLY USED WHEN CONSTRUCTION LIMITS ARE 2 OR MORE MILES IN LENGTH. ROUND UP TO NEXT WHOLE NUMBER. (NO FRACTIONAL OR DECIMAL NUMBERS)	
	3		<ul style="list-style-type: none"> PLACE INITIALLY AT THE CONSTRUCTION LIMITS AND SPACE 1 MILE APART THEREAFTER. AT TEE INTERSECTIONS INSTALL INITIALLY 1/2 MILE FROM INTERSECTION AND SPACE 1 MILE APART THEREAFTER. 	
	4		<ul style="list-style-type: none"> THESE ARE FOR -Y- LINES THAT ARE "THROUGH" ROADWAYS. DEAD END AND SUBDIVISION ROADS ARE NOT "THROUGH" ROADWAYS. INSTALL 500' +/- FROM EACH -Y- LINE APPROACH AS SHOWN ABOVE. FOR MULTIPLE -Y- LINES THAT ARE SEPARATED BY 0.25 MILES OR LESS, TREAT AS A SINGLE UNIT AND INSTALL WITHIN 500' OF EACH APPROACH. A MAXIMUM OF 2 SIGN SETS PER MILE. DO NOT INSTALL WHEN -Y- LINES ARE WITHIN 0.5 MILES FROM "END ROAD WORK" SIGN. FOR TEE INTERSECTIONS, INSTALL WITHIN 500' +/- OF THE INTERSECTION ALONG -L- LINE. 	
	5		PLACE 500' FOLLOWING THE END OF CONSTRUCTION LIMITS OR AS SHOWN WHEN WORK ENDS AT A 3-WAY TEE INTERSECTION.	

THE ABOVE SIGNS ARE ALL THAT ARE REQUIRED FOR A CONTRACTOR TO BEGIN A RESURFACING CONTRACT. ANY ADDITIONAL SIGNS REQUESTED BY NCDOT DIVISIONS SHALL BE INSTALLED WITHIN 7 BUSINESS DAYS OF THE START OF CONTRACT WORK.

MAPS LESS THAN 2 MILES

FOR RESURFACING MAPS WITH CONSTRUCTION LIMITS LESS THAN 2 MILES IN LENGTH, NO STATIONARY SIGNS ARE REQUIRED. USE PORTABLE "ROAD UNDER CONSTRUCTION" OR "ROAD WORK AHEAD" SIGNS IN LIEU OF STATIONARY ADVANCE WARNINGS SIGNS.

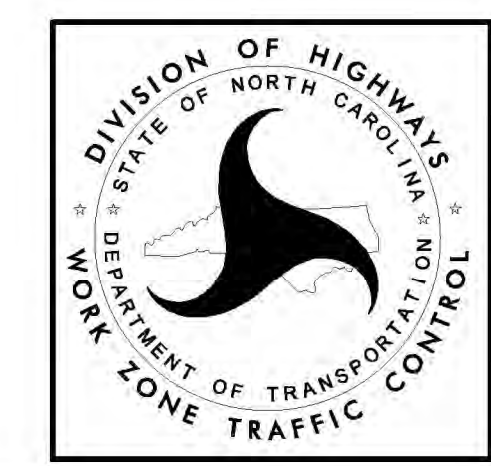

ADVANCE WARNING SIGNS FOR RURAL AND SUBURBAN 2-LANE ROADWAY RESURFACING

5/15/2017 5:11:10 PM \\NCDOT\Users\resurfacing\2122W & AST Resurfacing Details\Resurfacing_AdvWarn_2122.dgn User:keads

